



LEGEND

- 9 FORECOURT TREE PLANTING TO SHADE PAVEMENTS & SOFTEN BUILDING FACADES**

- 10** YOUTH PLACE SPACE & ENTRY

Disclaimer
These plans are for Client use and/or Council Approval only. Not intended for construction purpose unless specifically noted. The contractor intending to use these documents shall check and verify all works on site and report any discrepancy to the Landscape Architect prior to commencement. Failure to do so shall not be the responsibility of the Client or Landscape Architect.

Project & Client
Hillsong Greater West Development
† Water Street,
WERRINGTON, NSW 2747
for
Hillsong Church

Date 30/10/2017

Scale 1:500 @ A1 1:1000 @ A3

0 5 10 15 20 25 30m

Drawing Reference
15467-LDA01-5

LANDSCAPE DESIGN NOTES

The landscape design for the proposed Hillsong Greater West Development has been undertaken in conjunction with the Architects to allow for a strongly integrated and complimentary landscape and building design outcome.

LANDSCAPE VISION
The landscape design seeks to respect the sites context, its proposed uses and provide environmental benefit through sustainable design elements.

The landscape design is to be a contemporary expression through both hard and soft landscape treatments.

LANDSCAPE OPPORTUNITIES

The site has significant opportunities for a range of landscape treatments. These are:

- Streetscape works to the Lander Street extension**
Incorporating native street trees.
- Landscape Setback Zone to the Lander Street Extension**
Incorporating native trees, shrubs, grasses and groundcovers in raised gardens, allowing endemic planting to extend wildlife corridors, and biodiversity. Planting and mounded garden areas will screen adjoining carpark areas
- Carpark Areas**
The sites car park areas are to incorporate areas of permeable planting and rain gardens to the benefit of establishing native trees, shrubs and grasses within these paved spaces. Native planting is to feature.
- The Lawn and Plaza Spaces**
A large level lawn space surrounded by trees and garden areas with contemporary seating pavilions features as the centre piece of the landscape. Row planting of deciduous trees provides summer shade, autumn colour and winter sun to the garden and seating areas. Decorative shrub and groundcover planting provides interest through floral display and seasonal foliage colour changes. Tree planting within plaza spaces provides shade to adjoining pavements with seating areas adjacent to gardens.
- Youth Ministry Area**
A space connected to the main facility but of a distinct character with bold colours and graphics. A year round play space with seating areas for small groups or individual reflection.
- Childcare Space**
A highly designed play space to cater for childcare needs, formal and informal play
- Boundary Areas**
Back of house boundary areas and the northern car park boundary are to feature native screen plants to visually screen the adjoining residential property and Cobham Juvenile Justice Centre. The sites side and rear boundary areas are to be fenced with minimum 2.1 m high colour bond type fence.

SOFT LANDSCAPE TREATMENTS

All garden and lawn areas are to have soils improved using specially blended soils and conditioners to improve existing ground conditions. Water retention additives will also be used. All garden areas are to be mulched to assist plant establishment and edged for ease of maintenance.

HARD LANDSCAPE TREATMENTS

All hard landscape materials have been selected for their robust qualities, suitable for use and low maintenance.

EXISTING TREES

A number of existing trees are to be removed. Their removal is to be adequately compensated by the installation of new native trees across the site including

- Lander Street
- Landscape setback zone to Lander Street
- Car Park planting
- Boundary planting

The existing trees when removed are to be chipped and mulched and stockpiled on site for later use in the landscape

PLANT SPECIES

Native plant species have been selected using Penrith City Council recommended plant lists together with other species known to be suitable to the area and site conditions.

LANDSCAPE LEVELS

All pavements are to be designed to ensure DDA compliance
Re-use of site soils will establish mounded landscape areas to the site frontage and other areas within the site. The mounded garden areas will assist in screening car park areas and will not exceed 1:3 slopes in order to allow for ease of maintenance and plant establishment

SUSTAINABLE DESIGN INITIATIVES

- Re-use of site soils to create mounded landscape
- Permeable paving in car park areas
- Rain Gardens in car park areas for biofiltration of stormwater
- Endemic Native planting
- Re-use of site material, chipping and mulching of existing trees

CO-ORDINATED DESIGN PROPOSALS

The landscape design drawing are to be read in conjunction with the following documents

- Landscape Details and Specification Sheet for details
- Architects drawings for details of building design
- Survey as prepared by LTS Lockley
- Engineers drawings for erosion and sediment control measures

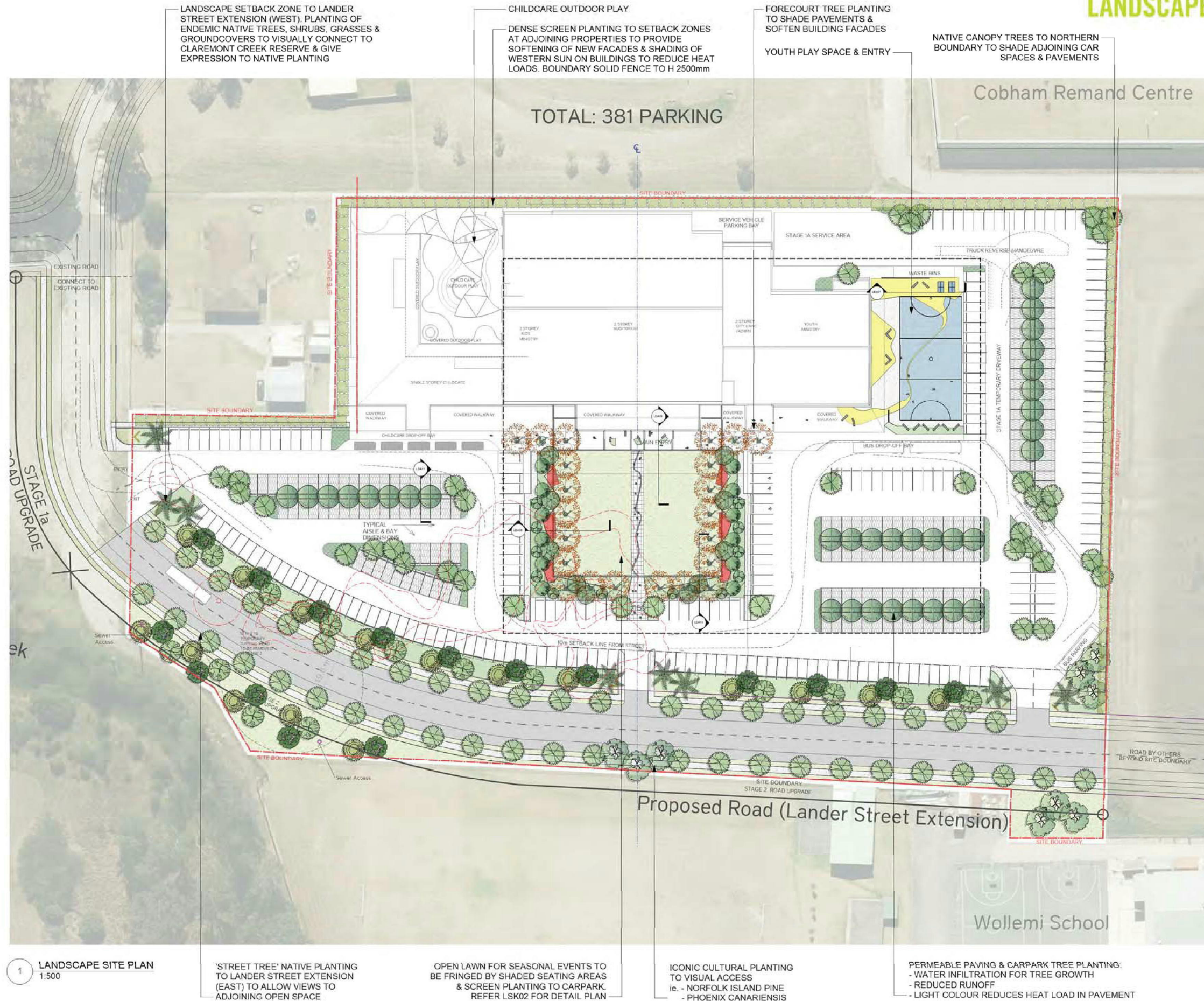

1 LANDSCAPE SITE PLAN
1:500

'STREET TREE' NATIVE PLANTING TO LANDER STREET EXTENSION (EAST) TO ALLOW VIEWS TO ADJOINING OPEN SPACE

OPEN LAWN FOR SEASONAL EVENTS TO BE FRINGED BY SHADED SEATING AREAS & SCREEN PLANTING TO CARPARK. REFER LSK02 FOR DETAIL PLAN

ICONIC CULTURAL PLANTING TO VISUAL ACCESS
ie. - NORFOLK ISLAND PINE
- PHOENIX CANARIENSIS

PERMEABLE PAVING & CARPARK TREE PLANTING:
- WATER INFILTRATION FOR TREE GROWTH
- REDUCED RUNOFF
- LIGHT COLOUR REDUCES HEAT LOAD IN PAVEMENT

Issue	No	Date	Description	Chkd
1	08/03/2017	Preliminary Landscape Structure Plan	AL	
2	20/03/2017	Preliminary Landscape Concept Plan	AL	
3	23/03/2017	Preliminary - For Client Review	AL	
4	17/05/2017	DA Tender	AL	
5	30/10/2017	DA	AL	

Disclaimer
These plans are for Client use and/or Council Approval only. Not intended for construction purpose unless specifically noted. The contractor intending to use these documents shall check and verify all works on site and report any discrepancy to the Landscape Architect prior to commencement. Failure to do so shall not be the responsibility of the Client or Landscape Architect.

Legend

- EXISTING TREES TO BE REMOVED
- EXISTING TREE CLUMPS TO BE REMOVED
- STREET & ORNAMENTAL PLANTING
- CARPARK TREE PLANTING
- CULTURAL PLANTING
- MIXED NATIVE TREE PLANTING
- SCREEN PLANTING
- PROPOSED SHRUBS & GROUNDCOVERS
- PROPOSED RAIN GARDEN
- PROPOSED TURF
- POROUS PAVING
- FEATURE PAVING

Drawing Title
Landscape Site Plan
Sheet 2 of 11

Project & Client
Hillsong Greater West Development

Water Street,
WERRINGTON, NSW 2747

for
Hillsong Church

Landscape Architect
NBRSARCHITECTURE.
Level 3, 4 Glen Street, Milsons Point, NSW 2061 Australia
T 61 2 9922 2344 F 61 2 9922 1308
E architects@nbrsap.com.au W www.nbrsap.com.au
Any form of reproduction of this drawing in full or in part without the written permission of NBR S & PARTNERS Pty Ltd constitutes an infringement of the copyright.
NBN 16 002 247 989
Homestead Architects: Geoffrey Dwyer reg No 3768; Andrew Duffin reg No 5682;
Larry Holdsworth reg No 5286
P:\Dgn-1915467\15467-ns\Consultant\1.Landscape

Date 30/10/2017
Scale 1:500 @ A1 1:1000 @ A3
0 5 10 15 20 25 30m
Drawing Reference
15467-LDA02-5